



Henshaw Street | London | SE17 1PE

Freehold

£795,000

- Three Double Bedrooms
- Victorian
- Garden
- Chain Free
- Elephant Park
- Elephant and Castle Station
- Local Amenities
- Renovation Project
- Kennington Station
- Borough Station





An attractive Victorian terraced house set over three floors located in Elephant and Castle. The property comprises of three double bedrooms, a large reception room with a separate dining area, a large kitchen area and bathroom in the popular Elephant and Castle. The property also benefits from a garden at the back. Located on an attractive tree-lined street, a short walk to Elephant and Castle tube station, and next door to the trendy Elephant Park, this house is in the ideal spot for convenient access to the city centre whilst in a charming residential area.





%epcGraph\_c\_1\_300%

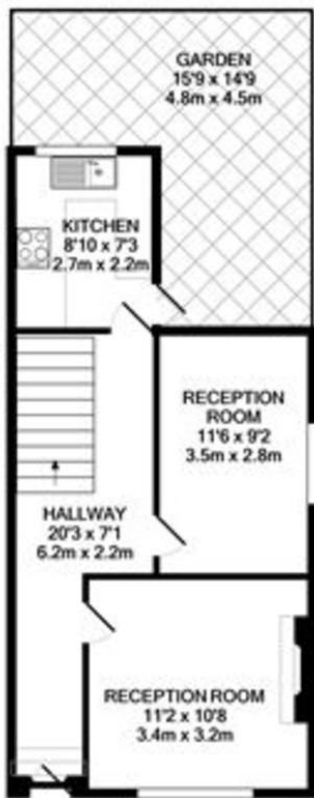

GROUND FLOOR  
APPROX. FLOOR  
AREA 397 SQ.FT.  
(36.8 SQ.M.)

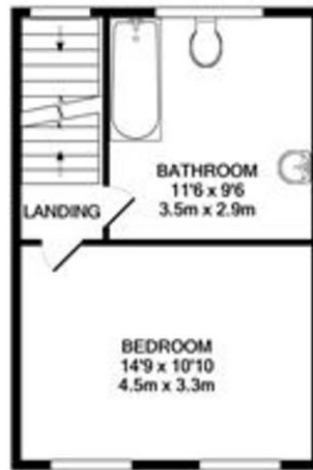

1ST FLOOR  
APPROX. FLOOR  
AREA 326 SQ.FT.  
(30.3 SQ.M.)

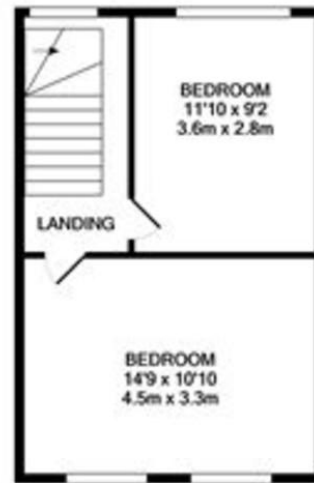

2ND FLOOR  
APPROX. FLOOR  
AREA 336 SQ.FT.  
(31.3 SQ.M.)

**TOTAL APPROX. FLOOR AREA 1059 SQ.FT. (98.4 SQ.M.)**

Whilst every attempt has been made to ensure the accuracy of the floor plan contained here, measurements of doors, windows, rooms and any other items are approximate and no responsibility is taken for any error, omission, or mis-statement. This plan is for illustrative purposes only and should be used as such by any prospective purchaser. The services, systems and appliances shown have not been tested and no guarantee as to their operability or efficiency can be given.  
Made with Metropix ©2020

## Viewing Arrangements

Strictly by appointment

## Contact Details

121 Denmark Hill

London

SE5 8EN

[www.urbanvillagehomes.co.uk](http://www.urbanvillagehomes.co.uk)

[sales@urbanvillagehomes.com](mailto:sales@urbanvillagehomes.com)

020 3519 9121

Agents Note: Whilst every care has been taken to prepare these sales particulars, they are for guidance purposes only. All measurements are approximate and for general guidance purposes only and whilst every care has been taken to ensure their accuracy, they should not be relied upon and potential buyers are advised to recheck the measurements