



Gilesmead | London | SE5

Leasehold

£575,000

- Top floor apartment
- Sought after location
- Interesting; architecturally
- Large kitchen diner
- Beautiful roof terrace
- Two double bedrooms
- Lots of built in storage
- Excellent transport links
- Very popular location
- Long Lease



Gilesmead is a very popular 1970's block nestled back from Camberwell Church Street with its well stocked floral planters, you are within close distance of the trendy Peckham nightlife, emerging scene of Camberwell Green and the ever popular Brixton. Local transport is excellent and you are surrounded by green spaces of Burgess Park, Ruskin Park and Camberwell Green, less than 2 miles South of London Bridge, you could hop on a bike and be Central in under half an hour. The apartment is large and well laid out, recently renovated with a stunning new kitchen. A beautiful roof terrace and two double bedrooms. You can see why Gilesmead apartments get snapped up. ** year lease, active residents association. Annual service charge £2200 includes heating, hot water, gated parking & buildings insurance.

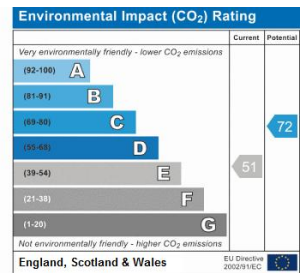
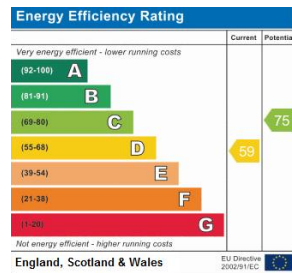

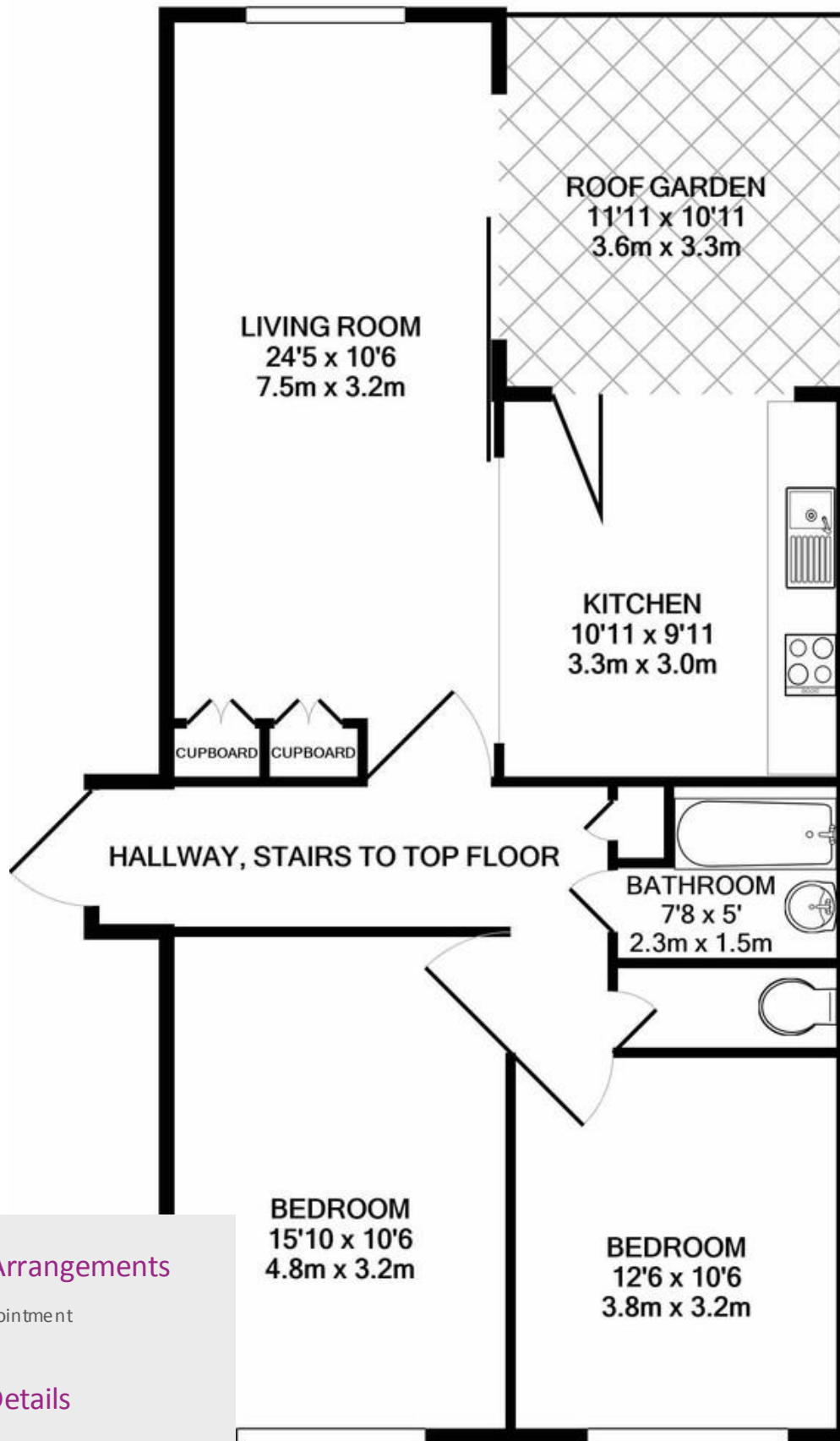

Viewing Arrangements

Strictly by appointment

Contact Details

121 Denmark Hill

London

SE5 8EN

www.urbanvillagehomes.co.uk

sales@urbanvillagehomes.com

020 3519 9121

APPROX. FLOOR AREA 836 SQ.FT. (77.6 SQ.M.)

It has been made to ensure the accuracy of the floor plan contained here, measurements are approximate and any other items are approximate and no responsibility is taken for any error.

Agents Note: Whilst every care has been taken to prepare these sales particulars, they are for guidance purposes only. All measurements are approximate and for general guidance purposes only and whilst every care has been taken to ensure their accuracy, they should not be relied upon and potential buyers are advised to recheck the measurements.