



Ruskin Park House | London | SE5  
8TQ

Share of freehold

£460,000

- Ruskin Park House
- Two double bedrooms
- Ground floor
- Garden outlook
- Beautiful interior design
- Balcony
- Stylish high gloss kitchen
- Bathroom and separate W.C
- Ruskin Park & KCH
- Denmark Hill station



A beautiful example of a Ruskin Park House apartment. The apartment is on the ground floor and overlooks the immaculate communal gardens. The lounge opens out to a balcony, with planters and a seating area. Modern fitted kitchen with built in appliances. There are two double bedrooms, bathroom and separate W.C. Parquet teak flooring throughout, the apartment has a really good feel to it. Ruskin Park House is a desirable building of purpose-built apartments, maintained to a high standard by the onsite estate manager and caretakers. The character of the block is sought after and due to the prohibition of renting the apartments out to tenants the estate maintains a community feel and familiarity. Very close to Denmark Hill station, Ruskin Park, Heme Hill and its Village farmers market, Peckham and Brixton with vibrant nightlife are close by. Share of freehold, long lease.

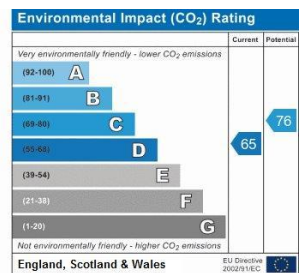
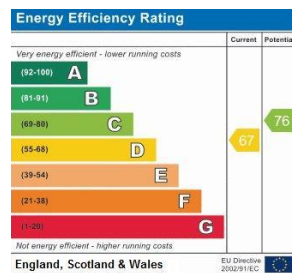

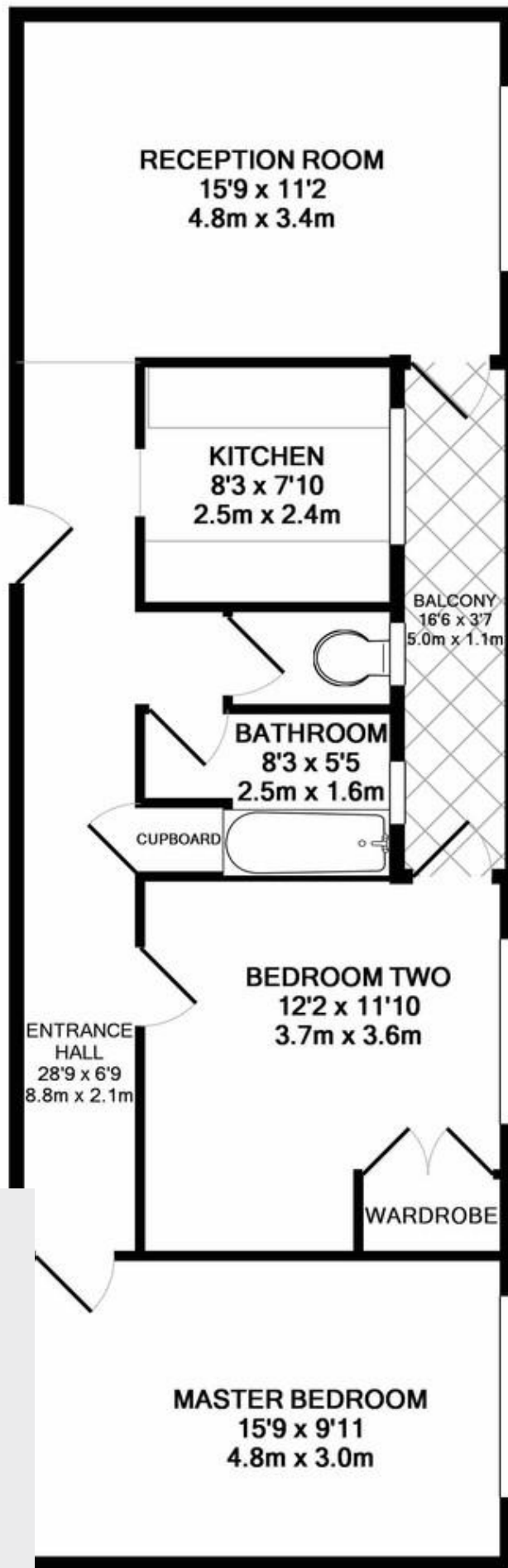

## Viewing Arrangements

Strictly by appointment

## Contact Details

121 Denmark Hill

London

SE5 8EN

[www.urbanvillagehomes.co.uk](http://www.urbanvillagehomes.co.uk)

[sales@urbanvillagehomes.com](mailto:sales@urbanvillagehomes.com)

020 3519 9121

Agents Note: Whilst every care has been taken to prepare these sales particulars, they are for guidance purposes only. All measurements are approximate and for general guidance purposes only and whilst every care has been taken to ensure their accuracy, they should not be relied upon and potential buyers are advised to recheck the measurements