



Ruskin Park House | London | SE5
8TN

Leasehold

£650,000

- Three double bedrooms
- Excellent condition
- Second floor
- Open plan lounge and dining room
- Two balconies
- Double aspect
- Lots of natural light
- Very spacious feel
- Excellent transport links
- Popular building



A beautiful three-bedroom apartment on the second floor of Ruskin Park House. Very spacious and bright with two balconies. Open plan living and entertaining space, with windows at either end and room to seat up to 14 people on a large dining table comfortably! High specification kitchen, polished cork flooring. All three bedrooms fit double beds. Family bathroom and separate laundry cupboard with washing machine and tumble dryer. Just two apartments on this level, likely the largest size of the Ruskin Park House apartments. Walking distance to Kings College Hospital, Denmark Hill Station, Herne Hill and Ruskin Park. Long Leasehold with share in the Landlord Company.

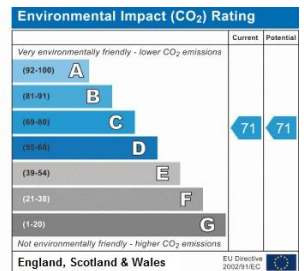
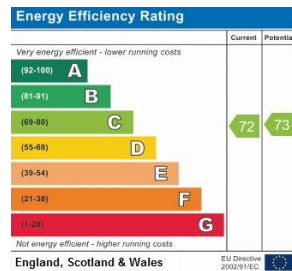

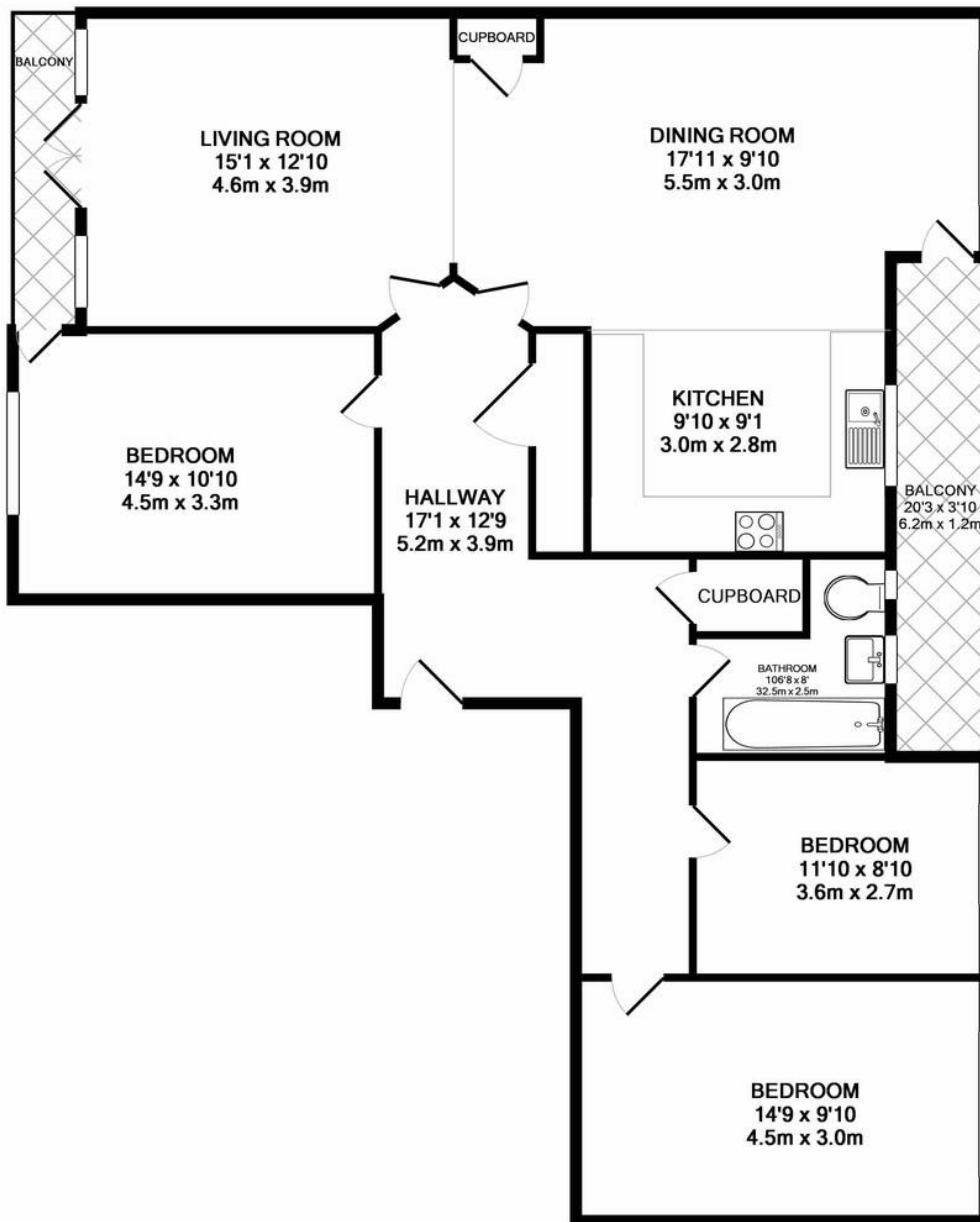

TOTAL APPROX. FLOOR AREA 1130 SQ.FT. (105.0 SQ.M.)

Whilst every attempt has been made to ensure the accuracy of the floor plan contained here, measurements of doors, windows, rooms and any other items are approximate and no responsibility is taken for any error, omission, or mis-statement. This plan is for illustrative purposes only and should be used as such by any prospective purchaser. The services, systems and appliances shown have not been tested and no guarantee as to their operability or efficiency can be given
 Made with Metropix ©2018

Viewing Arrangements

Strictly by appointment

Contact Details

121 Denmark Hill

London

SE5 8EN

www.urbanvillagehomes.co.uk

sales@urbanvillagehomes.com

020 3519 9121

Agents Note: Whilst every care has been taken to prepare these sales particulars, they are for guidance purposes only. All measurements are approximate are for general guidance purposes only and whilst every care has been taken to ensure their accuracy, they should not be relied upon and potential buyers are advised to recheck the measurements