



24a Wanless Road | London | SE24  
OHW

£1,600 pcm

- First floor apartment
- Built in 2015
- Immaculate
- Two double bedrooms
- Lots of natural light
- Open plan entertaining space
- Large balcony
- Walking dist. Brixton Tube
- Loughborough Junction
- King's College Hospital



Immaculate modern first floor apartment with large decked balcony. Bright and airy open plan living accommodation, ideal for entertaining and dinner parties. Two double bedrooms with fitted wardrobes and a large stylish bathroom. Built in 2015 to a high standard which has been maintained by the current owners. Clean lines, modern finishes and lots of natural light make this apartment stand out. Brixton tube is easily accessible and Brixton POP and vibrant Brixton Village are just a short walk away with a local gym just one road over. Loughborough Junction with direct, fast trains to Blackfriars & St. Pancras. Ruskin Park with it's summer bandstand concerts and village feel. Kings college hospital is a short walk. Unfurnished available 26th April

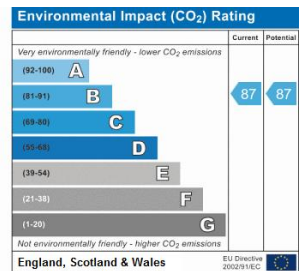
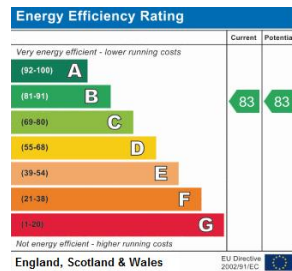

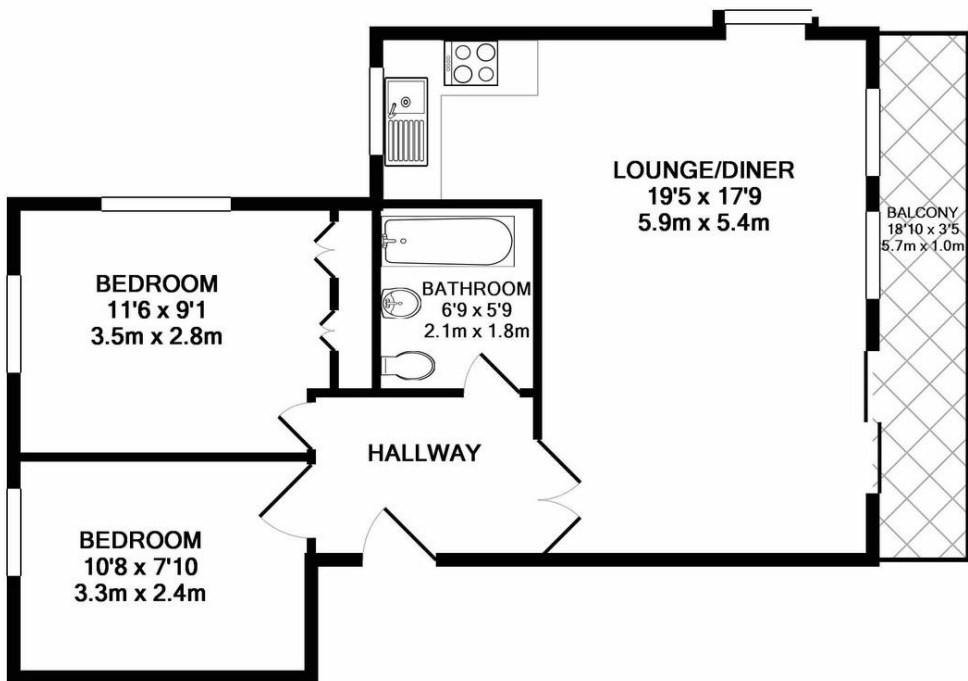

TOTAL APPROX. FLOOR AREA 547 SQ.FT. (50.8 SQ.M.)

Whilst every attempt has been made to ensure the accuracy of the floor plan contained here, measurements of doors, windows, rooms and any other items are approximate and no responsibility is taken for any error, omission, or mis-statement. This plan is for illustrative purposes only and should be used as such by any prospective purchaser. The services, systems and appliances shown have not been tested and no guarantee as to their operability or efficiency can be given  
 Made with Metropix ©2018

## Viewing Arrangements

Strictly by appointment

## Contact Details

121 Denmark Hill

London

SE5 8EN

[www.urbanvillagehomes.co.uk](http://www.urbanvillagehomes.co.uk)

[lettings@urbanvillagehomes.com](mailto:lettings@urbanvillagehomes.com)

020 3519 9121

Agents Note: Whilst every care has been taken to prepare these sales particulars, they are for guidance purposes only. All measurements are approximate and are for general guidance purposes only and whilst every care has been taken to ensure their accuracy, they should not be relied upon and potential buyers are advised to recheck the measurements