



Camberwell Church Street | SE5 7LN

Freehold

£525,000

- Two double bedrooms
- Private Garden
- Open plan
- Sought after block
- Excellent transport links
- Interesting; architecturally
- Camberwell Green
- Local Amenities
- Peckham
- Kings College Hospital and Ruskin Park



Gilesmead is a very popular 1970's block on Camberwell Church Street. This split level apartment has a light open plan ground floor that opens up to a private back garden. The well laid out second floor has a family bathroom, two good sized double bedrooms and heaps of storage. Within close distance of the trendy Peckham nightlife, emerging scene of Camberwell Green and the ever popular Brixton. Local transport is excellent and you are surrounded by green spaces of Burgess Park, Ruskin Park and Camberwell Green, less than 2 miles South of London Bridge, you could hop on a bike and be Central in under half an hour. 89 year lease, active residents association. Annual service charge £2200 includes heating, hot water, gated parking & buildings insurance.

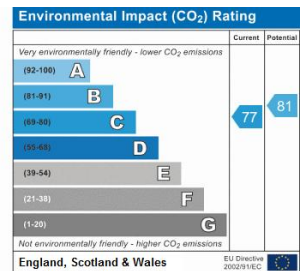
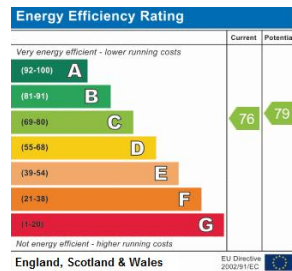

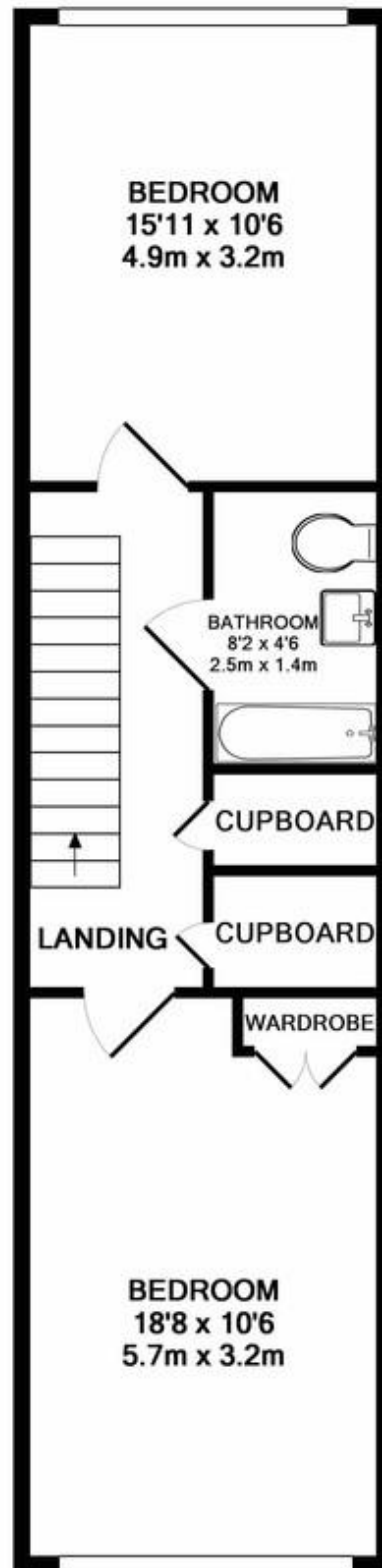
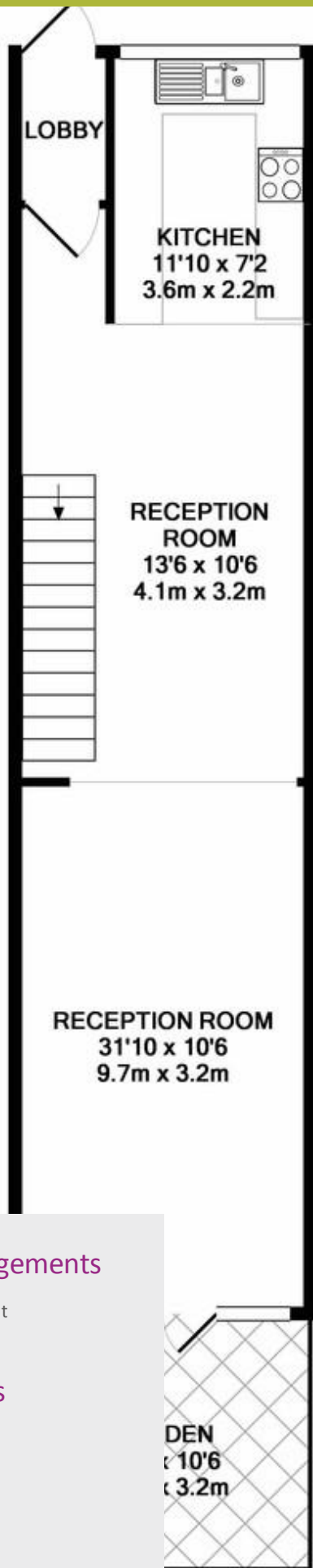

1ST FLOOR  
APPROX. FLOOR  
AREA 473 SQ.FT.  
(44.0 SQ.M.)

## Viewing Arrangements

Strictly by appointment

## Contact Details

121 Denmark Hill  
London  
SE5 8EN

[www.urbanvillagehomes.co.uk](http://www.urbanvillagehomes.co.uk)  
[sales@urbanvillagehomes.com](mailto:sales@urbanvillagehomes.com)  
020 3519 9121

Agents Note: Whilst every care has been taken to prepare these sales particulars, they are for guidance purposes only. All measurements are approximate and are for general guidance purposes only and whilst every care has been taken to ensure their accuracy, they should not be relied upon and potential buyers are advised to recheck the measurements