

Grove Lane | London | SE5

£1,550 pcm

- One Bedroom Apartment
- Large Reception Room
- Modern Kitchen
- Separate Toilet and Bathroom
- Period Property
- Denmark Hill Station
- Kings College Hospital
- Camberwell
- East Dulwich
- Ruskin Park



A bright and spacious one double bedroom flat, a moments walk away from Denmark Hill Station & Kings College Hospital. The flat is in a gorgeous Georgian conversion on Grove Lane. It is on the first floor and has large French doors in the main reception which open out onto a view of the salvation army campus. The kitchen is off the main reception and the bedroom faces the rear of the property and has large built in wardrobes. Walking distance to Peckham Rye, East Dulwich, and Camberwell shops, bars and restaurants. Parking via residents permit scheme.



Energy Efficiency Rating		Current	Potential
Very energy efficient - lower running costs			
(92-100)	A		
(81-91)	B		
(69-80)	C		77
(55-68)	D	62	
(39-54)	E		
(21-38)	F		
(1-20)	G		
Not energy efficient - higher running costs			

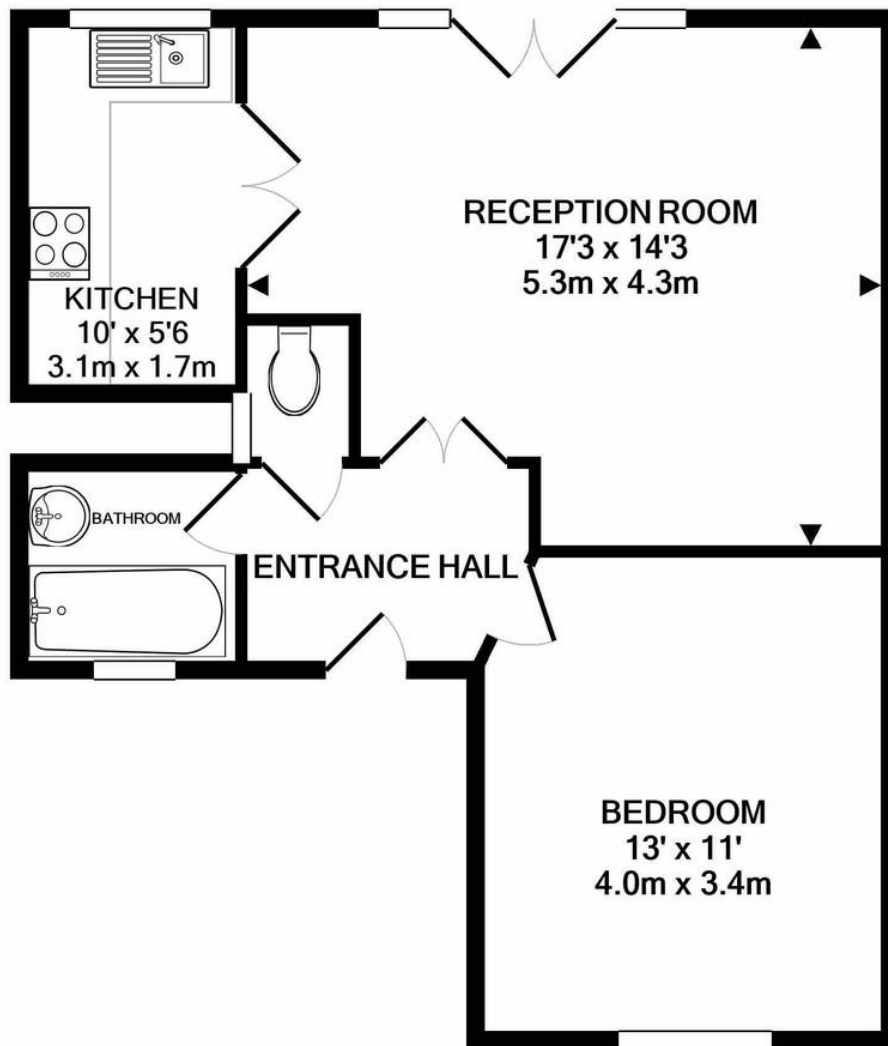

TOTAL APPROX. FLOOR AREA 499 SQ.FT. (46.3 SQ.M.)

Whilst every attempt has been made to ensure the accuracy of the floor plan contained here, measurements of doors, windows, rooms and any other items are approximate and no responsibility is taken for any error, omission, or mis-statement. This plan is for illustrative purposes only and should be used as such by any prospective purchaser. The services, systems and appliances shown have not been tested and no guarantee as to their operability or efficiency can be given

Made with Metropix ©2021

Viewing Arrangements

Strictly by appointment

Contact Details

121 Denmark Hill

London

SE5 8EN

www.urbanvillagehomes.co.uk

lettings@urbanvillagehomes.com

020 3519 9121

Agents Note: Whilst every care has been taken to prepare these sales particulars, they are for guidance purposes only. All measurements are approximate are for general guidance purposes only and whilst every care has been taken to ensure their accuracy, they should not be relied upon and potential buyers are advised to recheck the measurements