



Denmark Hill | Camberwell | SE5

Leasehold

£450,000

- Modern apartment
- Two double bedrooms
- Two bathrooms
- Excellent condition
- Open plan entertaining space
- Plenty of storage
- Private balcony
- Close to Kings College Hospital
- Herne Hill
- Denmark Hill Station



Lovely modern two double bedroom, two bathroom apartment with private balcony, very close to Kings College Hospital, Ruskin Park and Denmark Hill Station. Excellent condition throughout with plenty of storage. Open plan kitchen and entertaining space with integrated appliances. Excellent transport links to the City & West End, walking distance to bars and nightlife of Brixton and Peckham.



Score	Energy rating	Current	Potential
92+	<b>A</b>		
81-91	<b>B</b>		
69-80	<b>C</b>	75 C	75 C
55-68	<b>D</b>		
39-54	<b>E</b>		
21-38	<b>F</b>		
1-20	<b>G</b>		

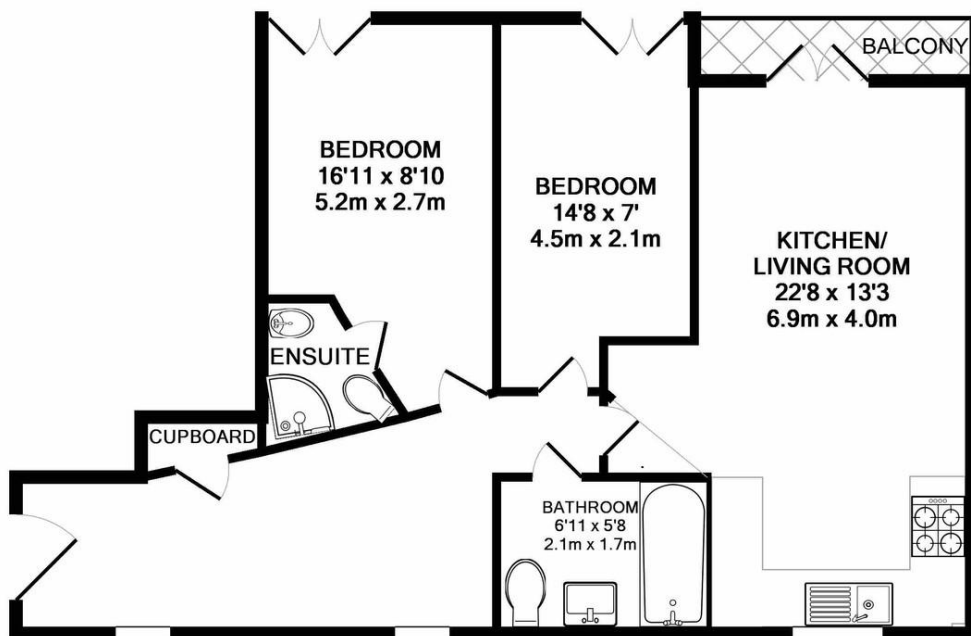

TOTAL APPROX. FLOOR AREA 607 SQ.FT. (56.4 SQ.M.)

Whilst every attempt has been made to ensure the accuracy of the floor plan contained here, measurements of doors, windows, rooms and any other items are approximate and no responsibility is taken for any error, omission, or mis-statement. This plan is for illustrative purposes only and should be used as such by any prospective purchaser. The services, systems and appliances shown have not been tested and no guarantee as to their operability or efficiency can be given  
 Made with Metropix ©2016

## Viewing Arrangements

Strictly by appointment

## Contact Details

121 Denmark Hill

London

SE5 8EN

[www.urbanvillagehomes.co.uk](http://www.urbanvillagehomes.co.uk)

[sales@urbanvillagehomes.com](mailto:sales@urbanvillagehomes.com)

020 3519 9121

Agents Note: Whilst every care has been taken to prepare these sales particulars, they are for guidance purposes only. All measurements are approximate are for general guidance purposes only and whilst every care has been taken to ensure their accuracy, they should not be relied upon and potential buyers are advised to recheck the measurements