



Champion Hill | London | SE5 8TL

Leasehold

£500,000

- Two double bedrooms
- Top floor
- Great views
- Modern Kitchen
- Lifts in the block
- Long Lease
- Communal Gardens
- Ruskin Park
- Denmark Hill Station
- Kings College Hospital



A beautiful two double bedroom apartment on the top floor of Ruskin Park House. A uniquely positioned, triple aspect flat which has panoramic city views and the largest of the two beds in the development. The living room benefits from plenty of natural light from the large south facing bay windows. There is a modern kitchen with integrated appliances and a family bathroom. parking spaces, garages and storage units are available to rent onsite.. Easy walking distance to Denmark Hill Station, King's College Hospital and Ruskin Park. Close to Herne Hill with its village market and lively Peckham and Brixton. Share of freehold company, long lease



%epcGraph_c_1_300%

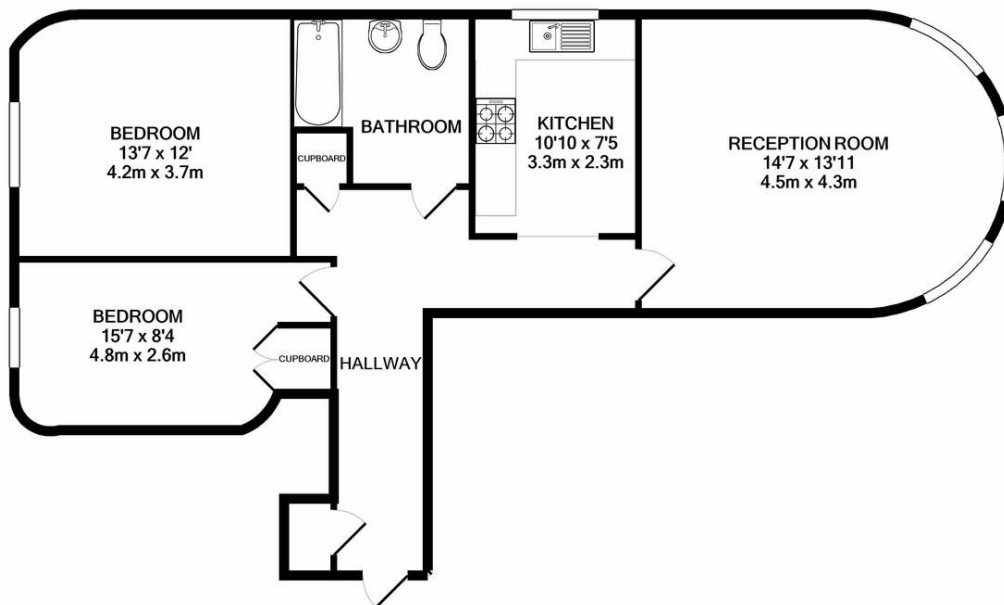

TOTAL APPROX. FLOOR AREA 835 SQ.FT. (77.6 SQ.M.)

Whilst every attempt has been made to ensure the accuracy of the floor plan contained here, measurements of doors, windows, rooms and any other items are approximate and no responsibility is taken for any error, omission, or mis-statement. This plan is for illustrative purposes only and should be used as such by any prospective purchaser. The services, systems and appliances shown have not been tested and no guarantee as to their operability or efficiency can be given

Made with Metropix ©2021

Viewing Arrangements

Strictly by appointment

Contact Details

121 Denmark Hill

London

SE5 8EN

www.urbanvillagehomes.co.uk

sales@urbanvillagehomes.com

020 3519 9121

Agents Note: Whilst every care has been taken to prepare these sales particulars, they are for guidance purposes only. All measurements are approximate are for general guidance purposes only and whilst every care has been taken to ensure their accuracy, they should not be relied upon and potential buyers are advised to recheck the measurements