



Choumert Grove | London | SE15

Freehold

£950,000

- Two double bedrooms
- Large private garden
- Period features
- Double fronted
- Family bathroom
- Excellent location
- Chain free
- Bellenden Road
- Local amenities
- Peckham





A gorgeous double fronted, two bedroom Victorian home situated in the prestigious Bellenden Village area. Character and charm throughout with a large sunny back garden. This pretty house is well configured with separate kitchen and dining room as well as cosy living room, all neutrally decorated through out. Positioned perfectly for the excellent array of local independent amenities of Peckham Rye and Overground station. The properties two well-proportioned double bedrooms, modern bathroom make the perfect base for a couple or small family.





Score	Energy rating	Current	Potential
92+	A		
81-91	B		88 B
69-80	C		
55-68	D	58 D	
39-54	E		
21-38	F		
1-20	G		

GROUND FLOOR  
400 sq.ft. (37.1 sq.m.) approx.

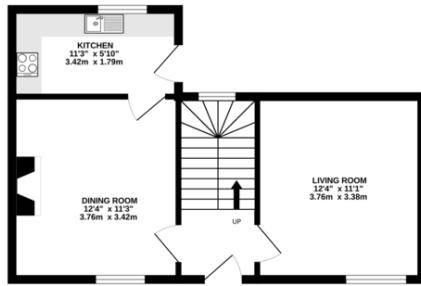

1ST FLOOR  
335 sq.ft. (31.2 sq.m.) approx.

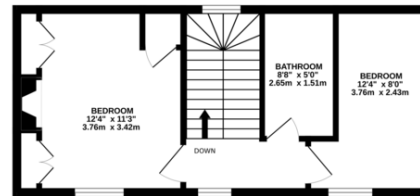

TOTAL FLOOR AREA: 735 sq.ft. (68.3 sq.m.) approx.

Whilst every attempt has been made to ensure the accuracy of the floorplan contained here, measurements of doors, windows, rooms and any other items are approximate and no responsibility is taken for any error, omission or mis-statement. This plan is for illustrative purposes only and should be used as such by any prospective purchaser. The services, systems and appliances shown have not been tested and no guarantee as to their operability or efficiency can be given.  
Made with Metropix 62025

## Viewing Arrangements

Strictly by appointment

## Contact Details

121 Denmark Hill

London

SE5 8EN

[www.urbanvillagehomes.co.uk](http://www.urbanvillagehomes.co.uk)

[sales@urbanvillagehomes.com](mailto:sales@urbanvillagehomes.com)

020 3519 9121

Agents Note: Whilst every care has been taken to prepare these sales particulars, they are for guidance purposes only. All measurements are approximate and are for general guidance purposes only and whilst every care has been taken to ensure their accuracy, they should not be relied upon and potential buyers are advised to recheck the measurements